



G A R I A

User's manual

TRIPL Urban Cargo Drive



Content

Symbols used in this manual	3
General safety	4
Specific safety	5
Main components	6
Controls	7
Instrument cluster	9
Product label	10
Parking brake	11
Ignition and steering lock	11
Seat adjustment	12
Charging	13
Recuperation	13
Lights	14
Replacement of the front light bulbs	14
Replacement of the stop light and rear light	15
Brake fluid	16
Jacking up the vehicle	17
Wheel change	18
Tyre pressure	18
Fuses	19
Emergency opening of the bonnet	20
Service intervals	21
Technical data	22
Main dimensions	22

Symbols used in this manual

The following symbols are used in this manual as well as the associated documentation supplied with the product.



WARNING

WARNING indicates a potentially hazardous situation which, if not avoided, could result in death or serious injury.



CAUTION

CAUTION indicates a potentially hazardous situation which, if not avoided, may result in minor or moderate injury. It may also be used to alert against unsafe practices.

IMPORTANT

IMPORTANT indicates important information about handling and use of the product.

NOTICE

NOTICE is used to address practices not related to personal safety.



Pinching/crushing hazard.



Electricity or potentially dangerous voltage.



Use protective gloves and eye wear.

General safety

WARNING

- Read and understand the manual completely before operating the vehicle.
- Comply with this manual to avoid accidents involving serious personal injury.
- Never handle this vehicle in other ways than are specified in this manual, as this can put your safety at risk and cause damage to the vehicle.
- Make sure that everyone who is to use the vehicle and its systems has the necessary information and access to this manual.

CAUTION

Please comply with these instructions to avoid the vehicle becoming damaged or destroyed.

NOTICE

We reserve the right to amend this manual without prior notice.

Specific safety



Crush hazard

Never sit or lie under the vehicle when it is jacked up. If the jack fails the vehicle can fall down on you! Jacks, hoists, or other lifting devices shall not be used beyond the safe load capacity recommended by the manufacturer.

Sudden movement hazard

Always apply the parking brake when leaving the vehicle. Always take the best safety precautions when releasing the parking brake. Vehicle can roll unexpectedly at all times when parking brake is released, even on level grounds. This can cause serious injury or death. Turn the ignition key to "Off" when not in use and remove the key.

Use

The vehicle's booth is intended for cargo only. Never use it for transport of people or animals. Do not allow unattended children on or near the vehicle.

The vehicle is intended for one person use only. Remain fully seated when operating the vehicle and hold on to the handlebars.

Driving

Drive slowly in turns as well as up and down slopes. When driving up and down slopes, drive straight up or down the slope rather than at an angle. Use brakes to reduce speed when driving downhill.

Do not operate the vehicle when under influence of alcohol or drugs.

Hot surfaces

Some of the engine parts become very hot during operation and shortly after shutdown. Keep hands and other body parts away from hot engine surfaces.

Fire hazard

Keep fire extinguishers handy. Clearly indicate the location of the fire extinguishers with a safety sign. Ensure that the types of fire extinguishers are appropriate for materials that might catch fire. Have all fire extinguishers checked and recharged periodically.

Modifications

Modifying or tampering with the vehicle could result in serious injury or death, as well as permanent damage to the vehicle. Any unauthorized modification of this vehicle will void all applicable warranties.

Main components

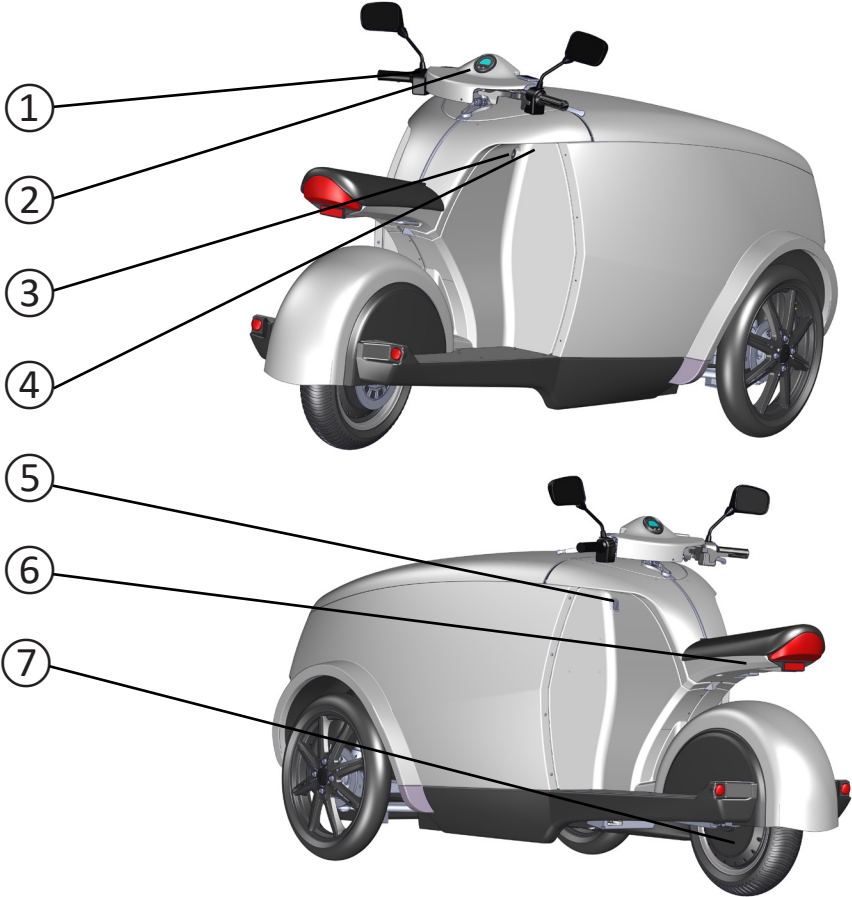

Component	
1	Handlebar
2	Instrument cluster
3	Ignition key
4	Boot release
5	Charger socket (See charger manual)
6	Adjustable seat
7	Motor

Controls

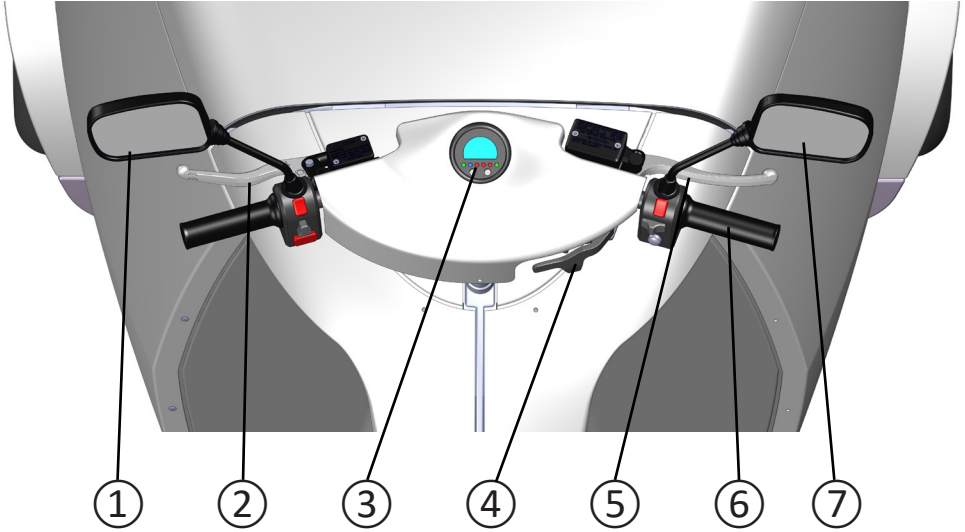

Component	
1	Left rearview mirror
2	Rear brake
3	Instrument cluster
4	Parking brake
5	Front brake
6	Hand throttle
7	Right rearview mirror

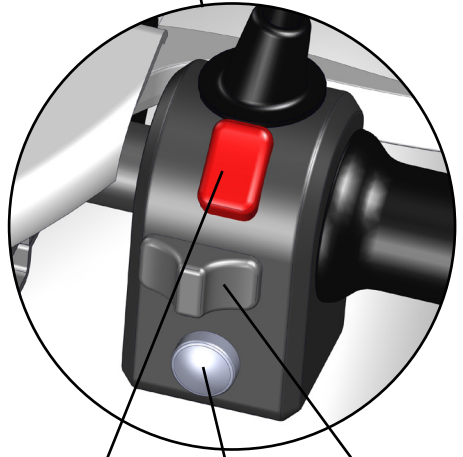
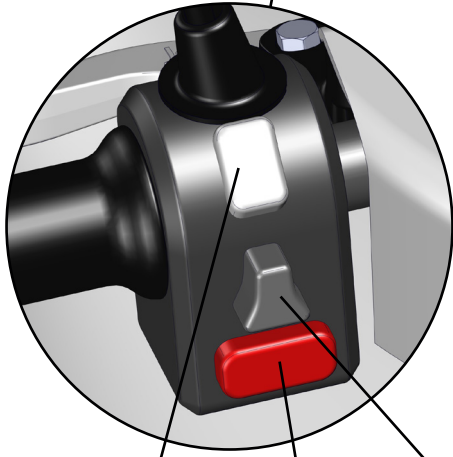
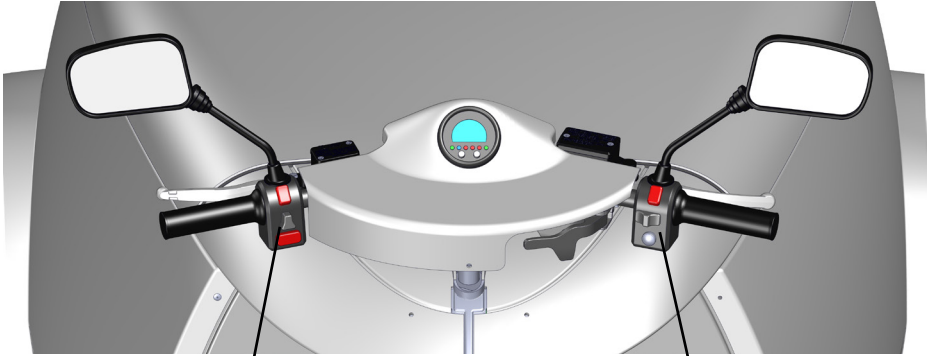

①

②

③

④

⑤

⑥

Component	
1	High beam
2	Horn
3	Indicators left/right
4	Hazard warning lights
5	Boost (Press and hold to boost the acceleration of the vehicle)
6	Forward / Reverse

Instrument cluster

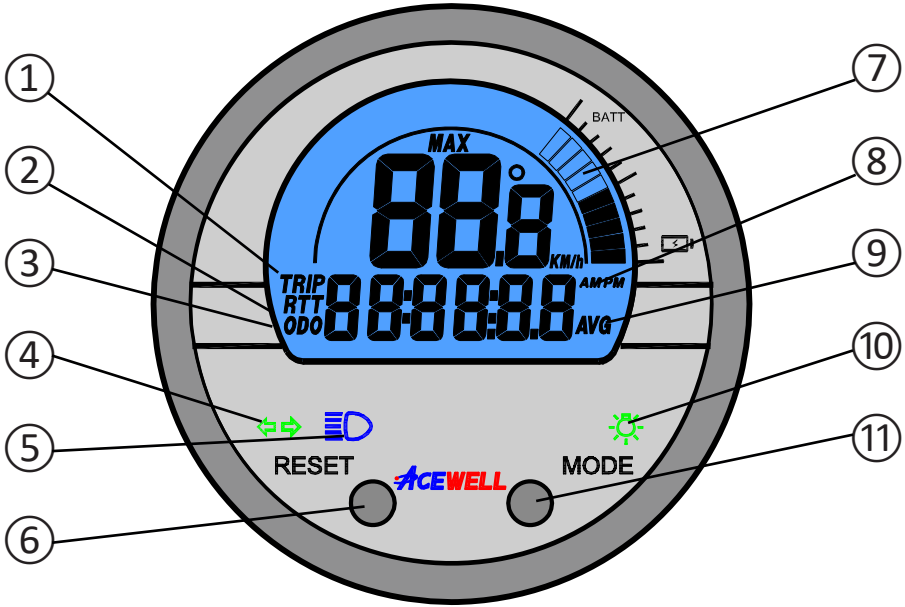

Component	
1	Trip
2	Riding time
3	Odometer
4	Indicators
5	High beam
6	Reset (Press in 3 sec.)
7	Battery gauge (See table at right)
8	Clock
9	Average speed
10	Low beam
11	Mode (Shift between modes)

Bars	Volt
10	>77,4
9	76,8~77,4
8	75,2~76,7
7	73,6~75,1
6	72,0~73,5
5	70,4~71,9
4	68,8~70,3
3	67,2~68,7
2	65,6~67,1 (FLASH)
1	< 65,5 (FLASH)

Product label

The manufacturer's plate ① and the stamped chassis number ② is placed inside the vehicles boot.



Parking brake



Sudden movement hazard

Always apply the parking brake when leaving the vehicle. Always take the best safety precautions when releasing the parking brake. Vehicle can roll unexpectedly at all times when parking brake is released, even on level grounds. This can cause serious injury or death. Turn the ignition key to "Off" when not in use and remove the key.

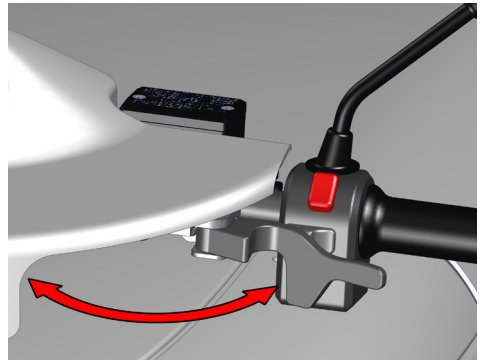

Pull out the handle to apply the parking brake.

Ignition and steering lock



Switch off the vehicle by turning the key to OFF. Turn the key to PUSH and push it in. When the steering lock is engaged, turn the key to LOCK and remove it.

The steering lock will engage when the handlebar is either to the left, the right or in the middle.

Seat adjustment

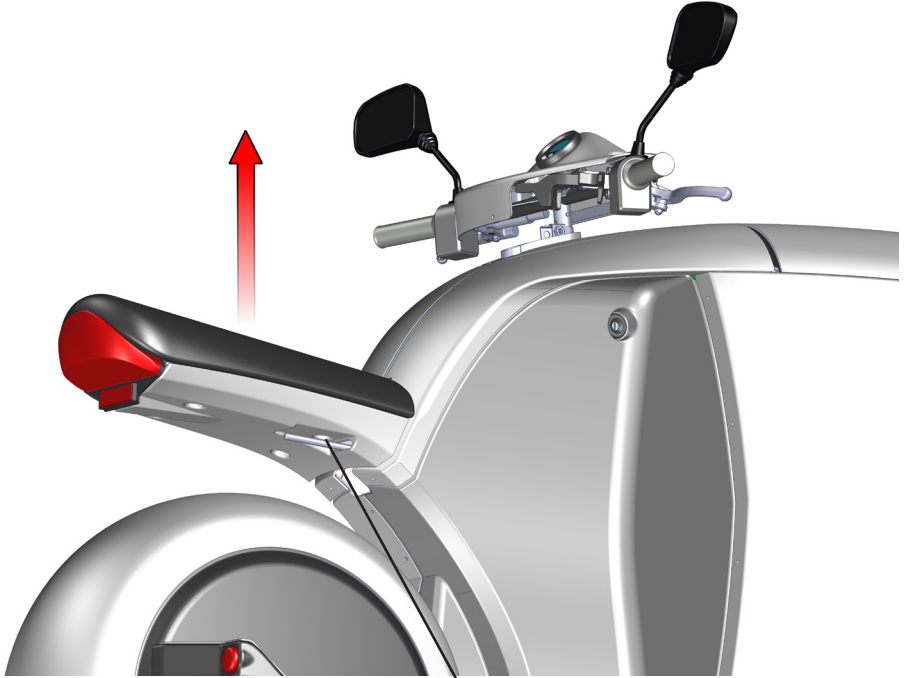

The seat height can be adjusted. Pull the seat adjustment handle and lift the seat to raise it. Push the seat to lower it. The handle will snap into place when released.

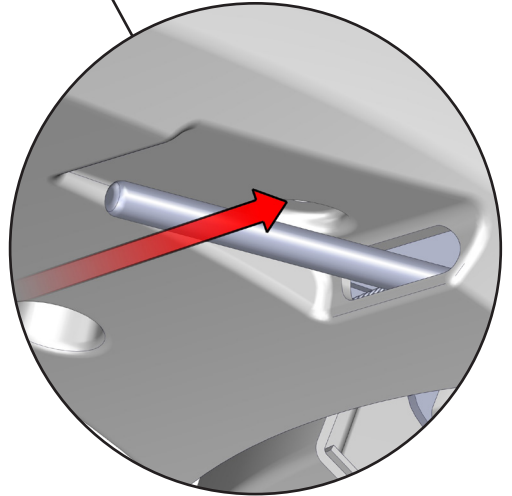

Charging

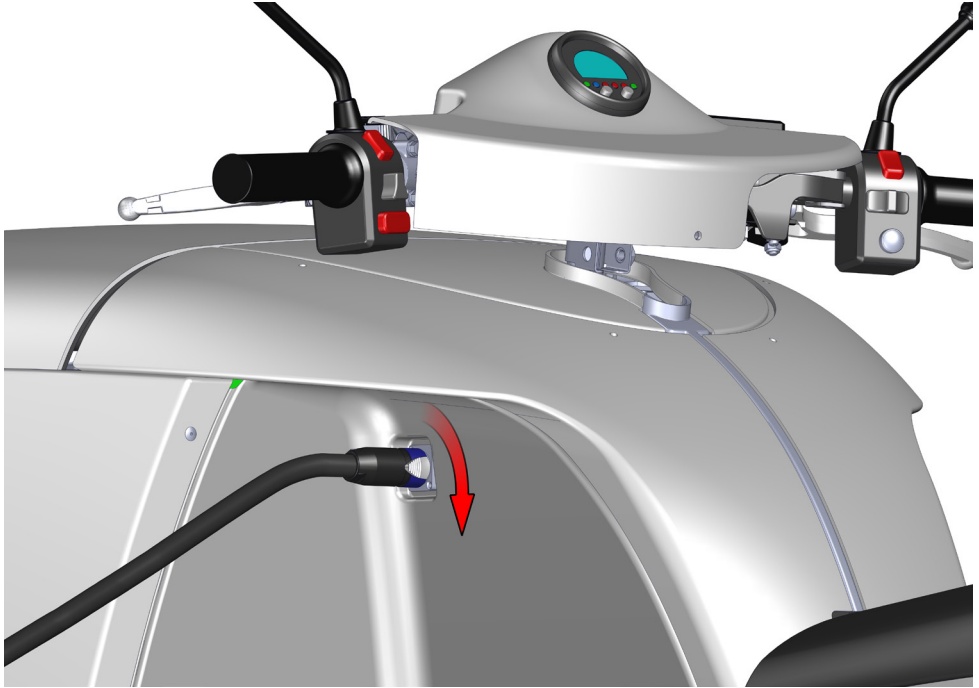

The charger connector must be turned 90° clockwise when inserted in the charger socket.

You must press the release button on the connector and turn it back again to release the connector.

Refer to the charger manual for details about charging the vehicle.

Recuperation

The vehicle can recuperate some of the brake energy. There are two recuperation modes:

- ① When you release the throttle the vehicle will slowly decelerate and recuperate a small amount of energy.
- ② When you briefly uses one of the brakes and let go of it again, the vehicle will quickly decelerate and recuperate a large amount of energy.

Lights

Replacement of the front light bulbs

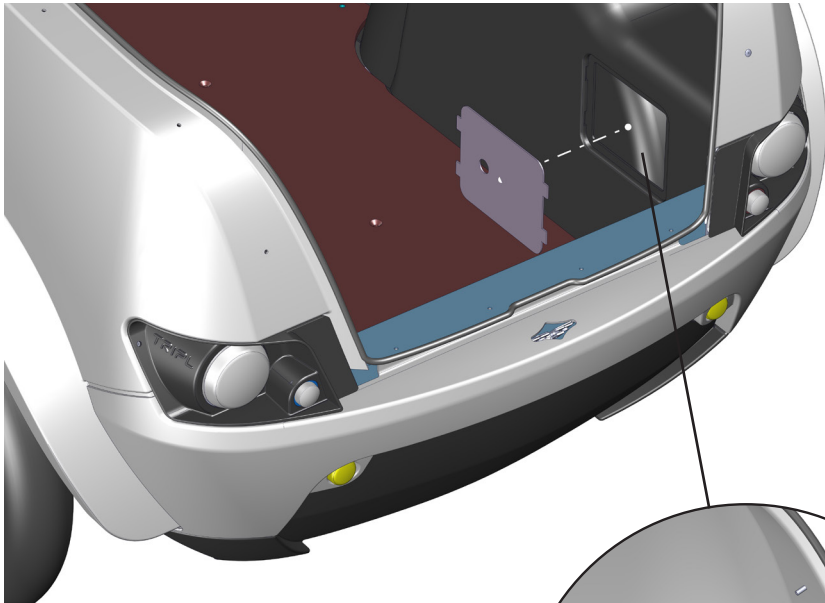

- ① Remove the cover for the light compartment.
- ② Unplug the wire and replace the light bulb.

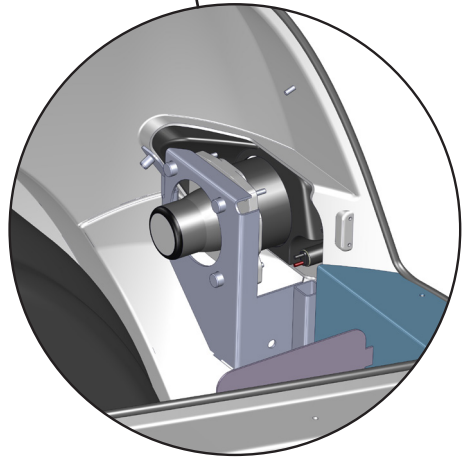

For replacement of the indicators and parking lights, refer to the vehicle's service manual.

Replacement of the stop light and rear light



- ① Unscrew the stop light/rear light unit. Unplug the wires from the unit.
- ② The light bulb is the double filament type containing both the stop light and the rear light. Replace the bulb if any of the lights are defective.

Brake fluid

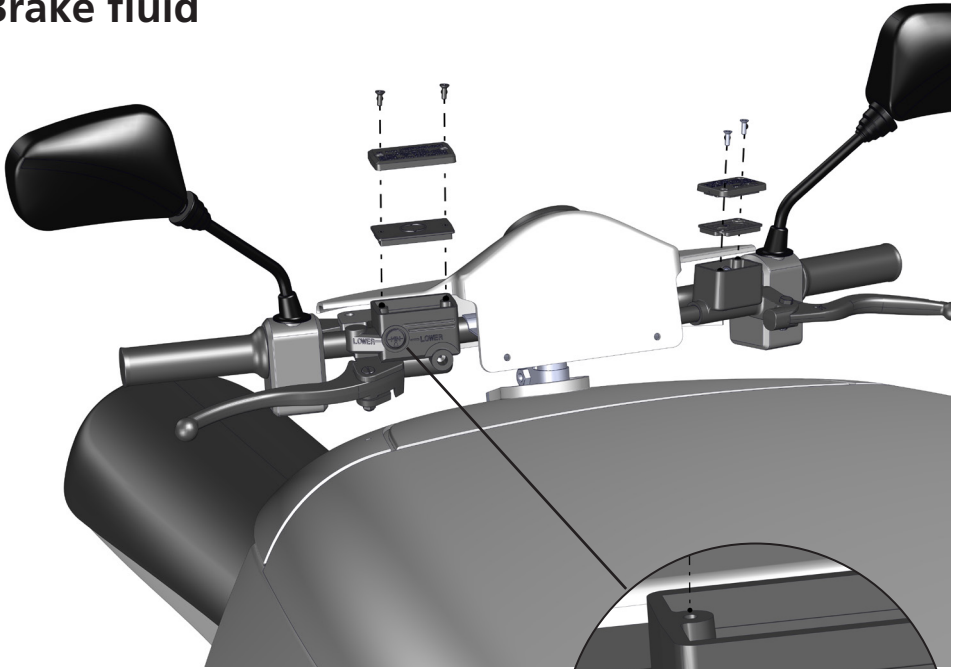

Check the brake fluid level by inspecting the spy glasses in the brake fluid reservoirs for both the front and the rear brake.

If the fluid level is below the LOWER mark, it must be topped up.

Remove the brake fluid reservoir cap and fill the reservoir until the brake fluid fill all of the spy glass.
Use Dot4 brake fluid.



Use protective gloves and eyewear when working with hydraulic brakes. Brake fluid can burn skin and eyes. Be careful not to spill brake fluid on the vehicle as this can damage the lacquer.

Jacking up the vehicle

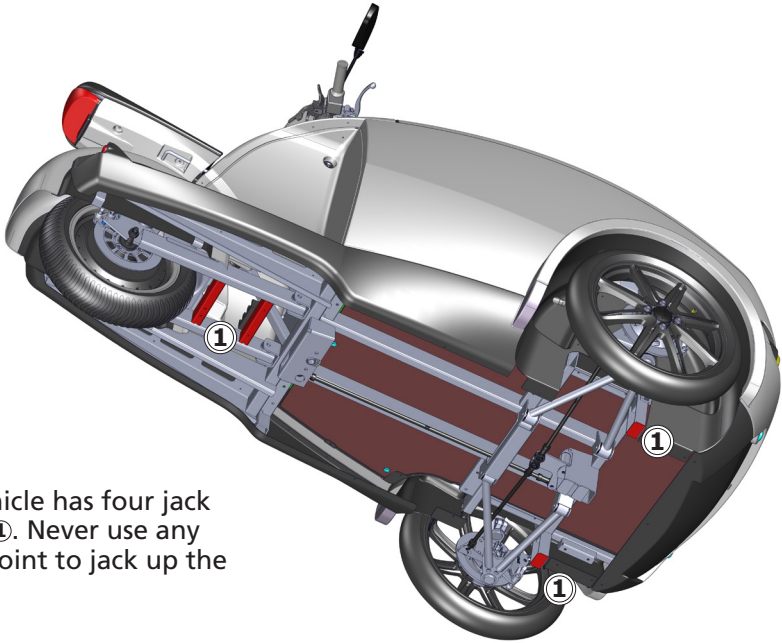

The vehicle has four jack points ①. Never use any other point to jack up the vehicle.



WARNING



Never sit or lie under the vehicle when it is jacked up. If the jack fails the vehicle can fall down on you! Jacks, hoists, or other lifting devices shall not be used beyond the safe load capacity recommended by the manufacturer. Never sit in vehicles being lifted by hydraulic lifts or jacks. Never work under vehicles that are not properly supported with approved stands. Makeshift stands made of wood, cement blocks, or boxes shall not be used.

Wheel change

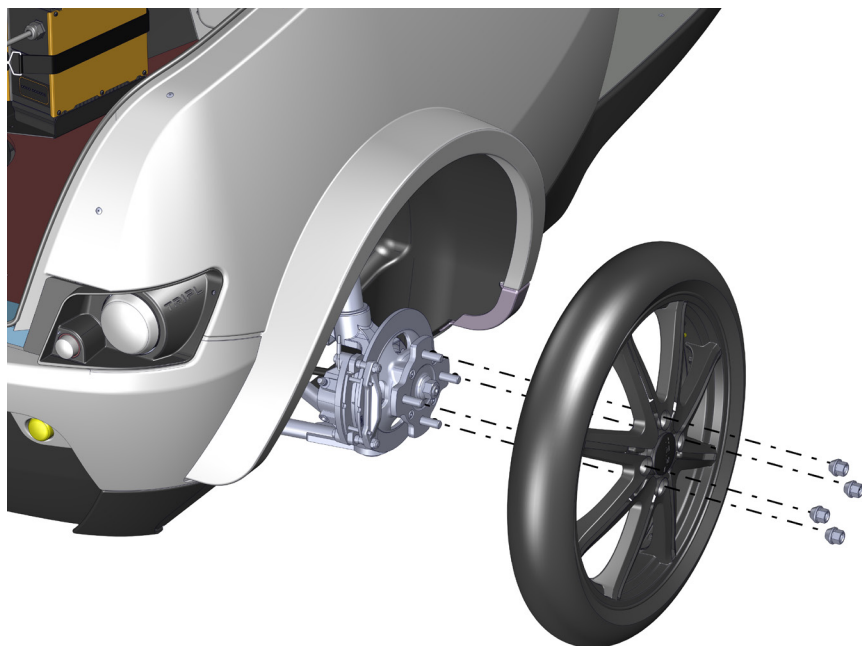

The front wheels can easily be removed and send to a workshop in case of a flat.

For removal of the rear wheel refer to the vehicle's Service Manual.

Tyre pressure

	Psi	Bar
Front wheels	36	2,5
Rear wheel	36	2,5

Fuses

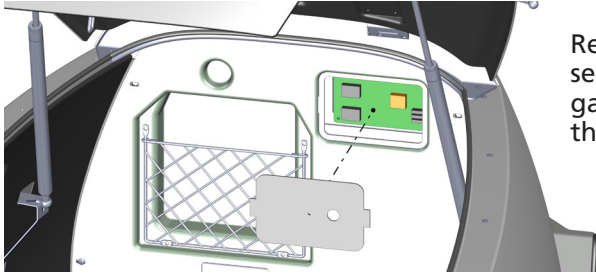

Remove the service hatch to gain access to the fuse box.

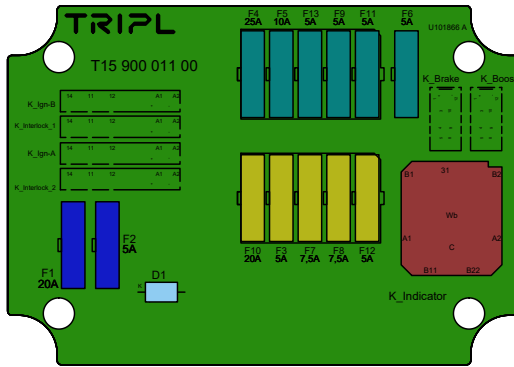

72V fuses (ATO type)		
#	Value	Function
F1	20A	Charger
F2	5A	DCDC converter
12V fuses (ATO type)		
F3	5A	12V unswitched supply
F4	25A	12V switched supply
F5	10A	Left controls
F6	5A	Rear lamp
F7	7,5A	Front left lamp, Front right position lamp
F8	7,5A	Front right lamp, Front left position lamp
F9	5A	Bonnet
F10	20A	AUX 12V
F11	5A	Instrument cluster
F12	5A	Brake light
F13	5A	Boost function

Emergency opening of the bonnet



In case of electrical failure or if the release cable is broken, it is possible to open the bonnet with the emergency release mechanism.

Insert a screwdriver or similar into the opening and push the latch sideways to unlock the bonnet.

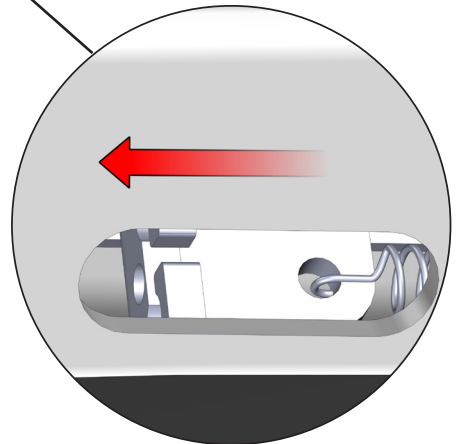

Service intervals

Months	6	12	18	24	30	36	42	48
Distance (1000 km)	10	20	30	40	50	60	70	80
Description								
Tire pressure	CA	CA	CA	CA	CA	CA	CA	CA
Visual inspection of tires and rims	C	C	C	C	C	C	C	C
Brake fluid	C/S	C/S	R	C/S	R	C/S	R	C/S
Battery mounting and liquid levels	C	S	S	S	S	S	S	S
Wires, battery cables and various connectors	CL	CL	CL	CL	CL	CL	CL	CL
Steering for free play	C	S	S	S	S	S	S	S
Shocks, springs and cuffs	C	C	C	C	C	C	C	C
Lights (front, rear, turn)	C/R	C/R	C/R	C/R	C/R	C/R	C/R	C/R
Wheel bearings, sound and free play	-	S	S	S	S	S	S	S
Toe in alignment	-	CA	CA	CA	CA	CA	CA	CA
Front brakes	C	S/CL	S/CL	S/CL	S/CL	S/CL	S/CL	S/CL
Rear brakes	C	S/CL	S/CL	S/CL	S/CL	S/CL	S/CL	S/CL
Discharge test	-	S	S	S	S	S	S	S
Front suspension wishbones	-	C	C	C	C	C	C	C
Rear suspension swing arm	-	C	C	C	C	C	C	C
Motor	-	C	C	C	C	C	C	C
Controller	-	C	C	C	C	C	C	C
Brake handles and throttle control	-	CA	C	CA	C	CA	C	CA
Seat adjustment	-	C	C	C	C	C	C	C
Side mirrors	-	C	C	C	C	C	C	C
Cluster (functionality / Service reset)	CA	CA	CA	CA	CA	CA	CA	CA
Dashboard buttons and switches	C	C	C	C	C	C	C	C

C = Check	S = Service
CA = Check & Adjust	CL = Clean & Lubricate
R = Replace	L = Lubricate

Technical data

Maximum permissible laden weight	596 kg
Maximum cargo	200 kg
Number of persons	1
Maximum velocity	45 kmh
Battery capacity	Up to 8,8 kWh
Range	Up to 100 km
Battery voltage	72 V Nominel

Main dimensions

